

SubConn® Low Profile

5 contacts

Connector specifications

| | |
|----------------------------|-------------------------------------------|
| Voltage rating | 600 V DC/AC rms |
| Current rating | 10 A per contact (max 40 A per connector) |
| Insulation resistance | > 200 Mohm |
| Contact resistance | < 0.01 ohm |
| Wet matings | > 500 (open face rated) |
| Temperature rating (water) | - 4 to 60°C, 25 to 140°F |
| Temperature rating (air) | - 40 to 60°C, - 40 to 140°F |
| Storage temperature rating | - 40 to 60°C, - 40 to 140°F |
| Qualified pressure tested | 800 bar, 11,600 psi |
| Depth rating PEEK | 300 bar, 4,350 psi |

Material specifications

| | |
|------------------------------|--------------------------------------------------------------|
| Connector body | Chloroprene rubber |
| Bulkhead body | Brass, stainless steel, titanium, anodised aluminium or PEEK |
| Contacts | Gold plated brass UNS - C36000 |
| O-rings | Nitrile |
| Locking strap | Chloroprene rubber |
| Inline cable (2 ft, 60 cm) | 18 AWG, 0.82 mm ² synthetic rubber |
| Bulkhead leads (1 ft, 30 cm) | 18 AWG, 0.82 mm ² coloured PTFE |
| OM leads (3", 7 cm) | 18 AWG, 0.82 mm ² coloured PTFE |

Face view (male)

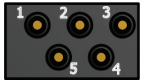

Inline cable colour code

| | |
|---------|----------|
| 1 Black | 4 Green |
| 2 White | 5 Orange |
| 3 Red | |

Nominal cable outside diameter (OD)

5 conductor cable 0.465", 11.8 mm

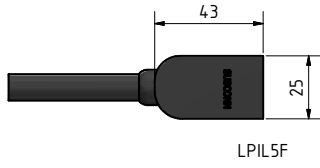

LPIL5F

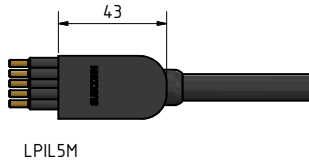

LPIL5M

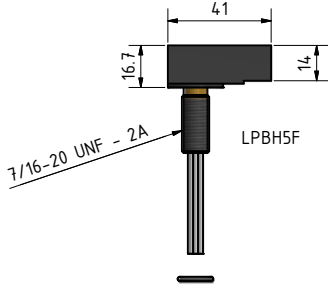
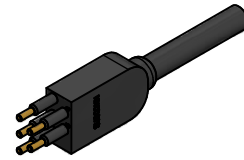

LPBH5F

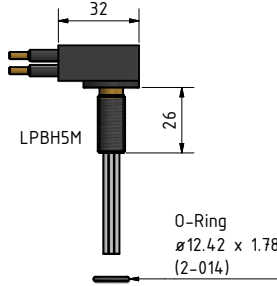

LPBH5M

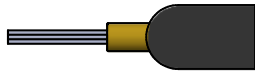
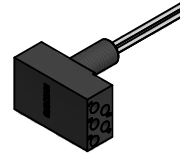

LPOM5F

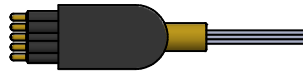

LPOM5M

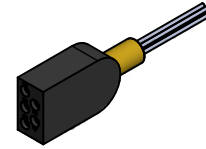

LPDC5F



LPDC5M

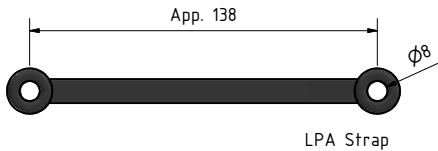
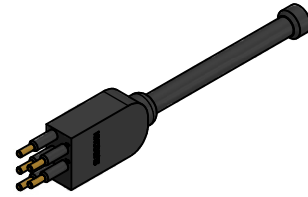

LPA Strap



Drawing information

Dimensions in mm (1 mm = 0.03937 inch)
Threads in inches (1 inch = 25.4 mm)